

## Meeting Stiles

Where pairs of doors are required, the meeting stiles are fitted with vertical sections to the edge of each door leaf preventing passage of flame, smoke and hot gases during a fire.

### Optional Meeting Stile Configurations

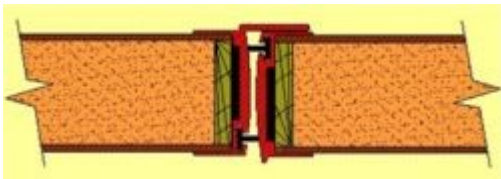

**Aluminium Single or Double T-Bar Meeting Stiles**

- Single T-Bar used in standard double leaf doors
- Double T-Bar is available for improved acoustic performance
- Fire rated up to 4 hours

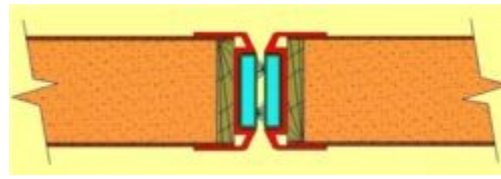

**Aluminium Bullnose Meeting Stiles**

- Used for double swing and push pull type doors
- Fire rated up to 2 hours

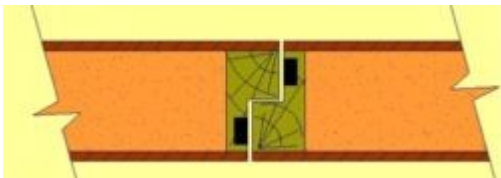

**Timber Rebated Meeting Stiles**

- For superior aesthetic appearance
- Fire rated up to 1 hour

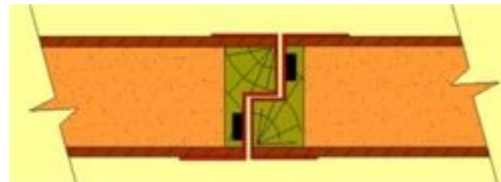

**Timber Rebated Meeting Stiles With Metal Capping**

- For aesthetic appearance and durability
- Fire rated up to 1 hour

For further information on these meeting stiles on double leaf doors, contact your local Trafalgar Sales Office.