

Horizontal one-sided bulkhead
60mm thick Maxilite boards, up to 1200mm wide

FRL
120/120/120
Fire from both directions

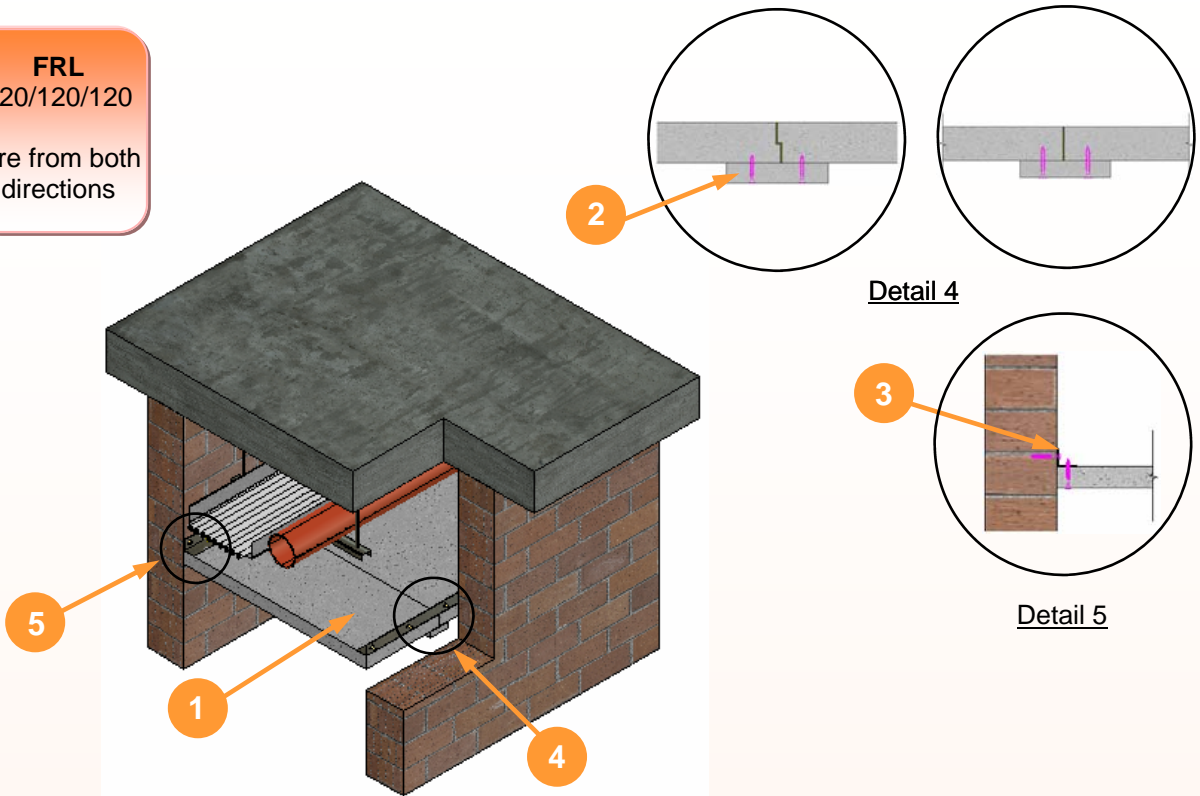

Key:

- 1 Maxilite boards, 60mm thick
- 2 Maxilite cover strips, 30mm thick x 100mm wide
- 3 Steel angles, 50mm x 50mm x 3mm
- 4 Rebate or butt joint detail options
- 5 Angle fixing details

Self-supporting system

Maxilite board	60mm thick board for 2 hour fire rating. Boards are joined together using rebate or butt joints incorporating approved fire mastic in all joints. Boards are screw-fixed to steel angles at max. 200mm centres.
Corners	Corners fixed to steel angles with self tapping screws at 200mm centres.
Joints	Boards are joined by either rebate or butt joints incorporating approved fire mastic. Cover strips are fixed over the joint.
Maxilite cover strips	30mm thick x 100mm wide fixed to outside of joint. Strips are secured to both sides of the joint at max. 200mm centres.
Steel angles	50mm x 50mm x 3mm, fixed to masonry, concrete or plasterboard at max. 600mm centres and screw-fixed to boards.
Fixings	<ul style="list-style-type: none"> - Board to board / steel angle: M4 - 100mm self tapping screws at 200mm centres. Allow 10 to 15mm from edges of Maxilite board. - Steel angle to masonry or concrete: M6 anchor bolts at 600mm centres. - Steel angle to plasterboard: M4 - 100mm self tapping screws at 600mm centres.

BULKHEAD — HORIZONTAL

Horizontal two-sided bulkhead 60mm thick Maxilite boards, up to 1200mm x 1200mm

FRL
120/120/120
Fire from both directions

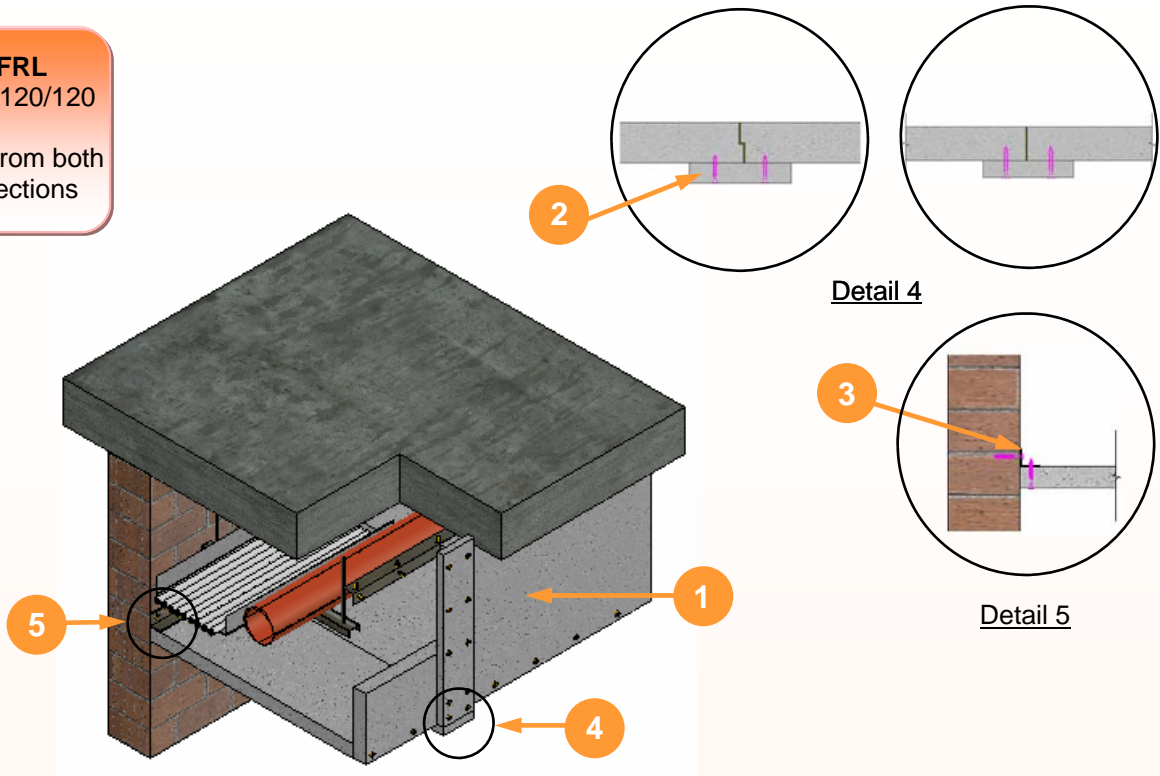

Key:

- 1 Maxilite boards, 60mm thick
- 2 Maxilite cover strips, 30mm thick x 100mm wide
- 3 Steel angles, 50mm x 50mm x 3mm
- 4 Rebate or butt joint detail options
- 5 Angle fixing details

Self-supporting system

Maxilite board	60mm thick board for 2 hour fire rating. Boards are joined together using rebate or butt joints incorporating approved fire mastic in all joints. Boards are screw-fixed to steel angles at max. 200mm centres.
Corners	Corners fixed to steel angles with self tapping screws at 200mm centres.
Joints	Boards are joined by either rebate or butt joints incorporating approved fire mastic. Cover strips are fixed over the joint.
Maxilite cover strips	30mm thick x 100mm wide fixed to outside of joint. Strips are secured to both sides of the joint at max. 200mm centres.
Steel angles	50mm x 50mm x 3mm, fixed to masonry, concrete or plasterboard at max. 600mm centres and screw-fixed to boards.
Fixings	<ul style="list-style-type: none"> - Board to board / steel angle: M4 - 100mm self tapping screws at 200mm centres. Allow 10 to 15mm from edges of Maxilite board. - Steel angle to masonry or concrete: M6 anchor bolts at 600mm centres. - Steel angle to plasterboard: M4 - 100mm self tapping screws at 600mm centres.

BULKHEAD — HORIZONTAL

Horizontal three-sided bulkhead
60mm thick Maxilite boards, up to 1200mm x 1200mm

FRL
120/120/120
Fire from both directions

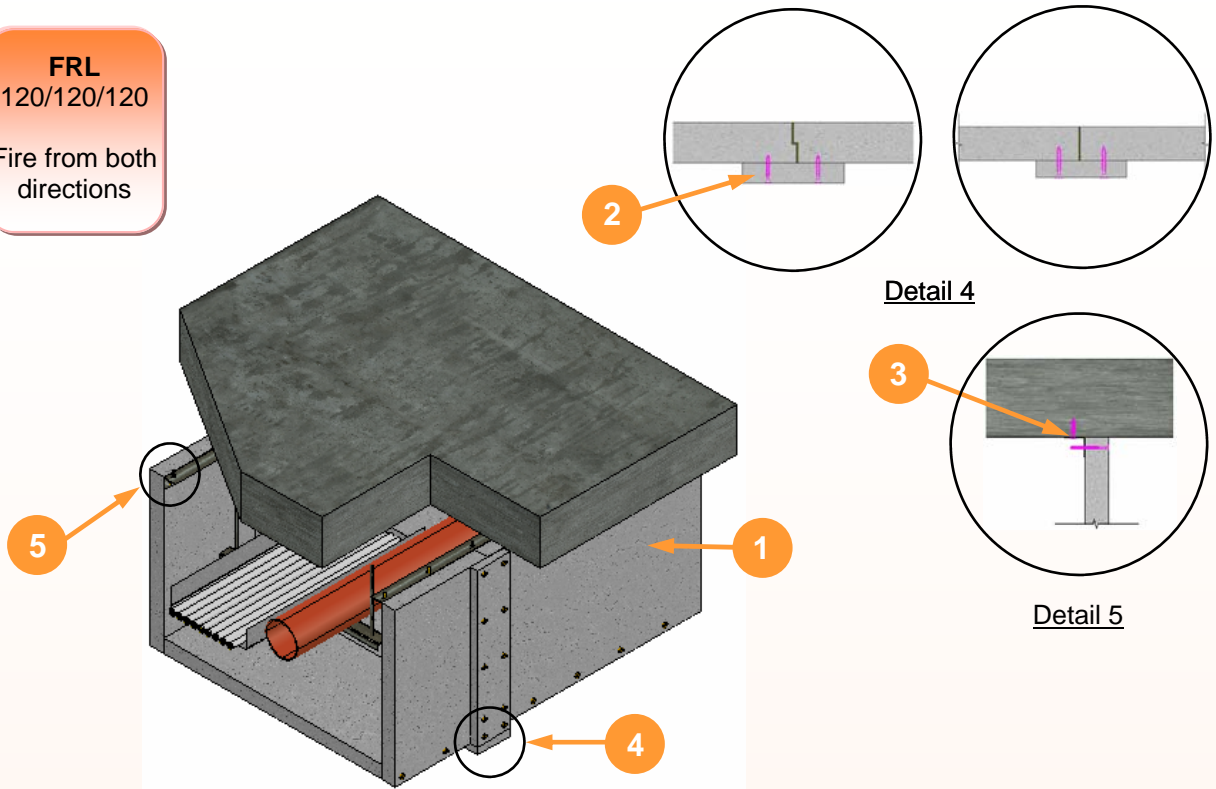

Key:

- 1 Maxilite boards, 60mm thick
- 2 Maxilite cover strips, 30mm thick x 100mm wide
- 3 Steel angles, 50mm x 50mm x 3mm
- 4 Rebate or butt joint detail options
- 5 Angle fixing details

Self-supporting system

Maxilite board	60mm thick board for 2 hour fire rating. Boards are joined together using rebate or butt joints incorporating approved fire mastic in all joints. Boards are screw-fixed to steel angles at max. 200mm centres.
Corners	Corners fixed to steel angles with self tapping screws at 200mm centres.
Joints	Boards are joined by either rebate or butt joints incorporating approved fire mastic. Cover strips are fixed over the joint.
Maxilite cover strips	30mm thick x 100mm wide fixed to outside of joint. Strips are secured to both sides of the joint at max. 200mm centres.
Steel angles	50mm x 50mm x 3mm, fixed to masonry, concrete or plasterboard at max. 600mm centres and screw-fixed to boards.
Fixings	<ul style="list-style-type: none"> - Board to board / steel angle: M4 - 100mm self tapping screws at 200mm centres. Allow 10 to 15mm from edges of Maxilite board. - Steel angle to masonry or concrete: M6 anchor bolts at 600mm centres. - Steel angle to plasterboard: M4 - 100mm self tapping screws at 600mm centres.

BULKHEAD — HORIZONTAL

Horizontal one-sided bulkhead 60mm thick Maxilite boards, up to 1200mm x 1200mm

FRL
240/240/240
Fire from both directions

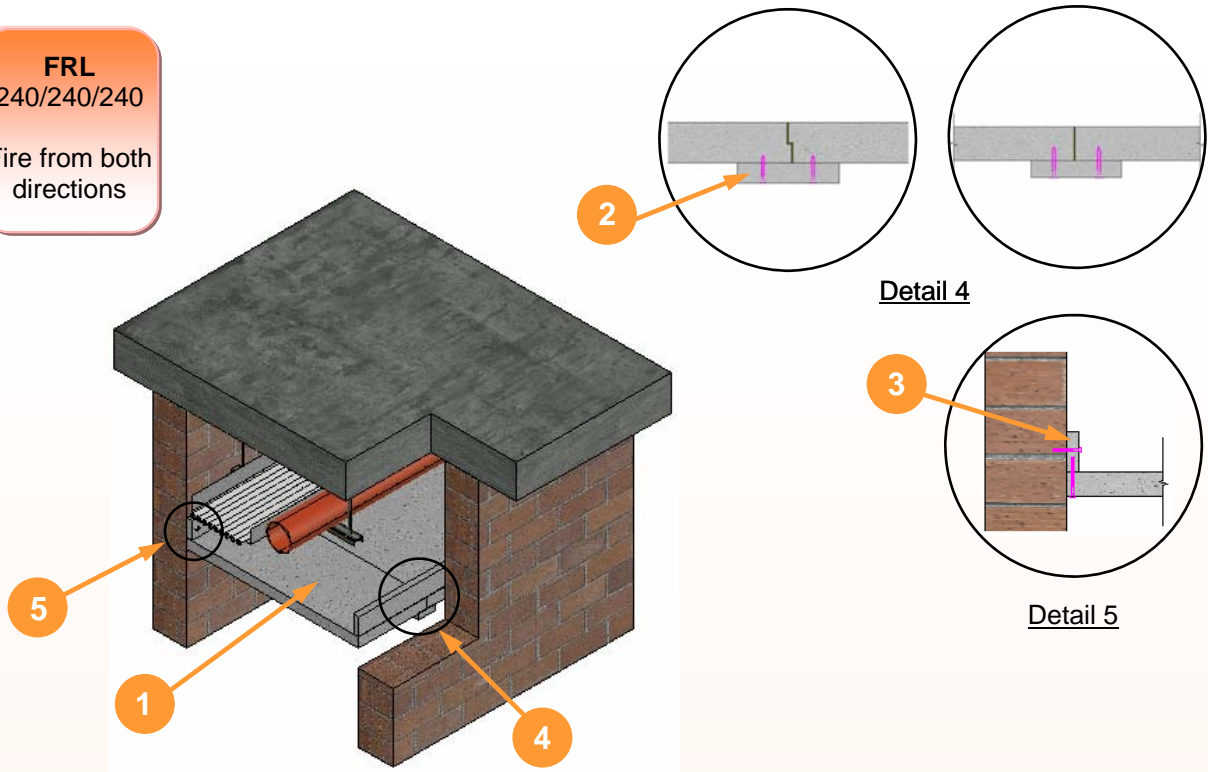

Key:

- 1 Maxilite boards, 60mm thick
- 2 Maxilite cover strips, 30mm thick x 100mm wide
- 3 Maxilite fillets, 30mm thick x 100mm wide
- 4 Rebate or butt joint detail options
- 5 Fillet fixing details

Self-supporting system

Maxilite board	60mm thick board for 4 hour fire rating. Boards are joined together using rebate or butt joints incorporating approved fire mastic in all joints. Boards are screw-fixed to fillets at max. 200mm centres.
Corners	Corners fixed to fillets or adjoining board with self tapping screws at 200mm centres.
Joints	Boards are joined by either rebate or butt joints incorporating approved fire mastic. Cover strips are fixed over the joint.
Maxilite cover strips	30mm thick x 100mm wide fixed to outside of joint. Strips are secured to both sides of the joint at max. 200mm centres.
Maxilite fillets	30mm thick x 100mm wide, fixed to masonry, concrete or plasterboard at max. 600mm centres and screw-fixed to boards.
Fixings	Board to board: M4 - 100mm self tapping screws at 200mm centres. Allow 10 to 15mm from edges of Maxilite board. Fillets to masonry or concrete: M6 anchor bolts at 600mm centres. Fillets to plasterboard: M4 - 100mm self tapping screws at 600mm centres.

BULKHEAD — HORIZONTAL

Horizontal two-sided bulkhead
60mm thick Maxilite boards, up to 1200mm x 1200mm

FRL
240/240/240
Fire from both directions

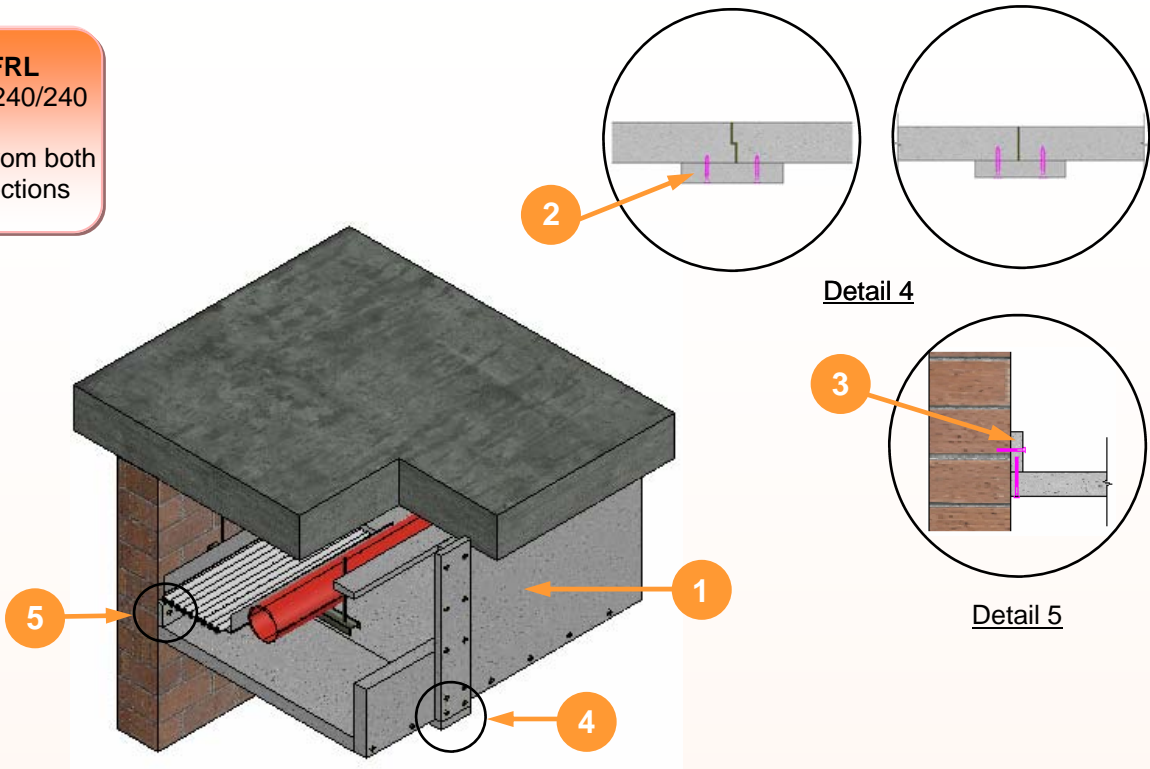

Key:

- 1 Maxilite boards, 60mm thick
- 2 Maxilite cover strips, 30mm thick x 100mm wide
- 3 Maxilite fillets, 30mm thick x 100mm wide
- 4 Rebate or butt joint detail options
- 5 Fillet fixing details

Self-supporting system

Maxilite board	60mm thick board for 4 hour fire rating. Boards are joined together using rebate or butt joints incorporating approved fire mastic in all joints. Boards are screw-fixed to fillets at max. 200mm centres.
Corners	Corners fixed to fillets or adjoining board with self tapping screws at 200mm centres.
Joints	Boards are joined by either rebate or butt joints incorporating approved fire mastic. Cover strips are fixed over the joint.
Maxilite cover strips	30mm thick x 100mm wide fixed to outside of joint. Strips are secured to both sides of the joint at max. 200mm centres.
Maxilite fillets	30mm thick x 100mm wide, fixed to masonry, concrete or plasterboard at max. 600mm centres and screw-fixed to boards.
Fixings	Board to board: M4 - 100mm self tapping screws at 200mm centres. Allow 10 to 15mm from edges of Maxilite board. Fillets to masonry or concrete: M6 anchor bolts at 600mm centres. Fillets to plasterboard: M4 - 100mm self tapping screws at 600mm centres.

BULKHEAD — HORIZONTAL

Horizontal three-sided bulkhead
60mm thick Maxilite boards, up to 1200mm x 1200mm

FRL
240/240/240
Fire from both directions

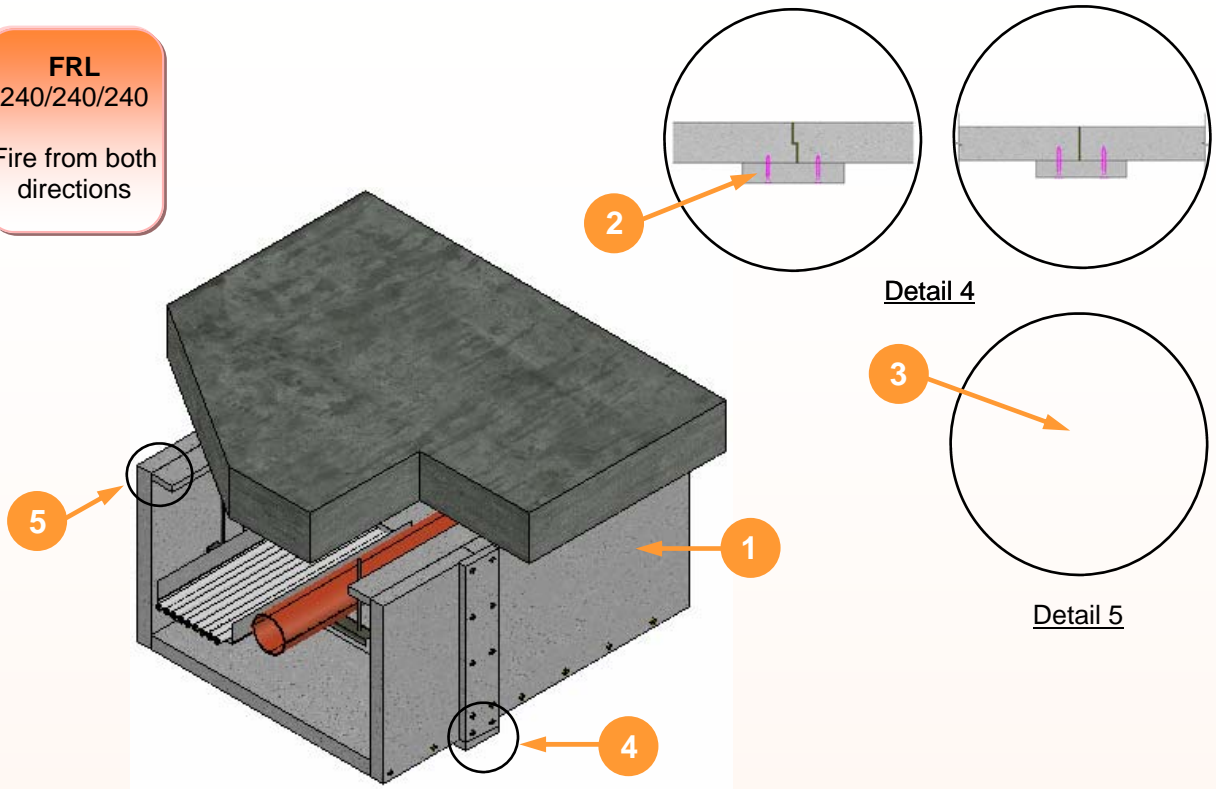

Key:

- 1 Maxilite boards, 60mm thick
- 2 Maxilite cover strips, 30mm thick x 100mm wide
- 3 Maxilite fillets, 30mm thick x 100mm wide
- 4 Rebate or butt joint detail options
- 5 Fillet fixing details

Self-supporting system

Maxilite board	60mm thick board for 4 hour fire rating. Boards are joined together using rebate or butt joints incorporating approved fire mastic in all joints. Boards are screw-fixed to fillets at max. 200mm centres.
Corners	Corners fixed to fillets or adjoining board with self tapping screws at 200mm centres.
Joints	Boards are joined by either rebate or butt joints incorporating approved fire mastic. Cover strips are fixed over the joint.
Maxilite cover strips	30mm thick x 100mm wide fixed to outside of joint. Strips are secured to both sides of the joint at max. 200mm centres.
Maxilite fillets	30mm thick x 100mm wide, fixed to masonry, concrete or plasterboard at max. 600mm centres and screw-fixed to boards.
Fixings	Board to board: M4 - 100mm self tapping screws at 200mm centres. Allow 10 to 15mm from edges of Maxilite board. Fillets to masonry or concrete: M6 anchor bolts at 600mm centres. Fillets to plasterboard: M4 - 100mm self tapping screws at 600mm centres.

BULKHEAD — HORIZONTAL

Vertical one-sided bulkhead 60mm thick Maxilite boards, up to 1200mm wide

FRL
120/120/120
Fire from both directions

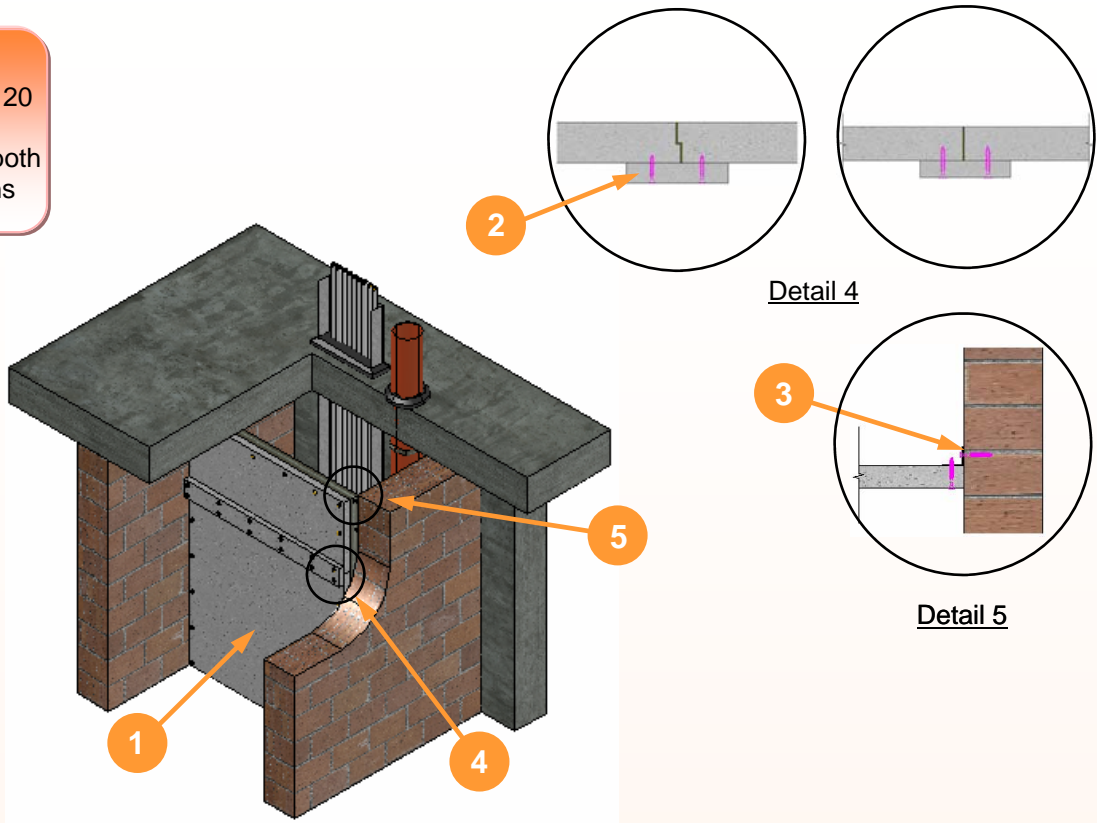

Key:

- 1 Maxilite boards, 60mm thick
- 2 Maxilite cover strips, 30mm thick x 100mm wide
- 3 Steel angles, 50mm x 50mm x 3mm
- 4 Rebate or butt joint detail options
- 5 Angle fixing details

Self-supporting system

Maxilite board	60mm thick board for 2 hour fire rating. Boards are joined together using rebate or butt joints incorporating approved fire mastic in all joints. Boards are screw-fixed to steel angles at max. 200mm centres.
Corners	Corners fixed to steel angles with self tapping screws at 200mm centres.
Joints	Boards are joined by either rebate or butt joints incorporating approved fire mastic. Cover strips are fixed over the joint.
Maxilite cover strips	30mm thick x 100mm wide fixed to outside of joint. Strips are secured to both sides of the joint at max. 200mm centres.
Steel angles	50mm x 50mm x 3mm, fixed to masonry, concrete or plasterboard at max. 600mm centres and screw-fixed to boards.
Fixings	- Board to board / steel angle: M4 - 100mm self tapping screws at 200mm centres. Allow 10 to 15mm from edges of Maxilite board. - Steel angle to masonry or concrete: M6 anchor bolts at 600mm centres. - Steel angle to plasterboard: M4 - 100mm self tapping screws at 600mm centres.

BULKHEAD — VERTICAL

Vertical two-sided bulkhead 60mm thick Maxilite boards, up to 1200mm x 1200mm

FRL
120/120/120
Fire from both directions

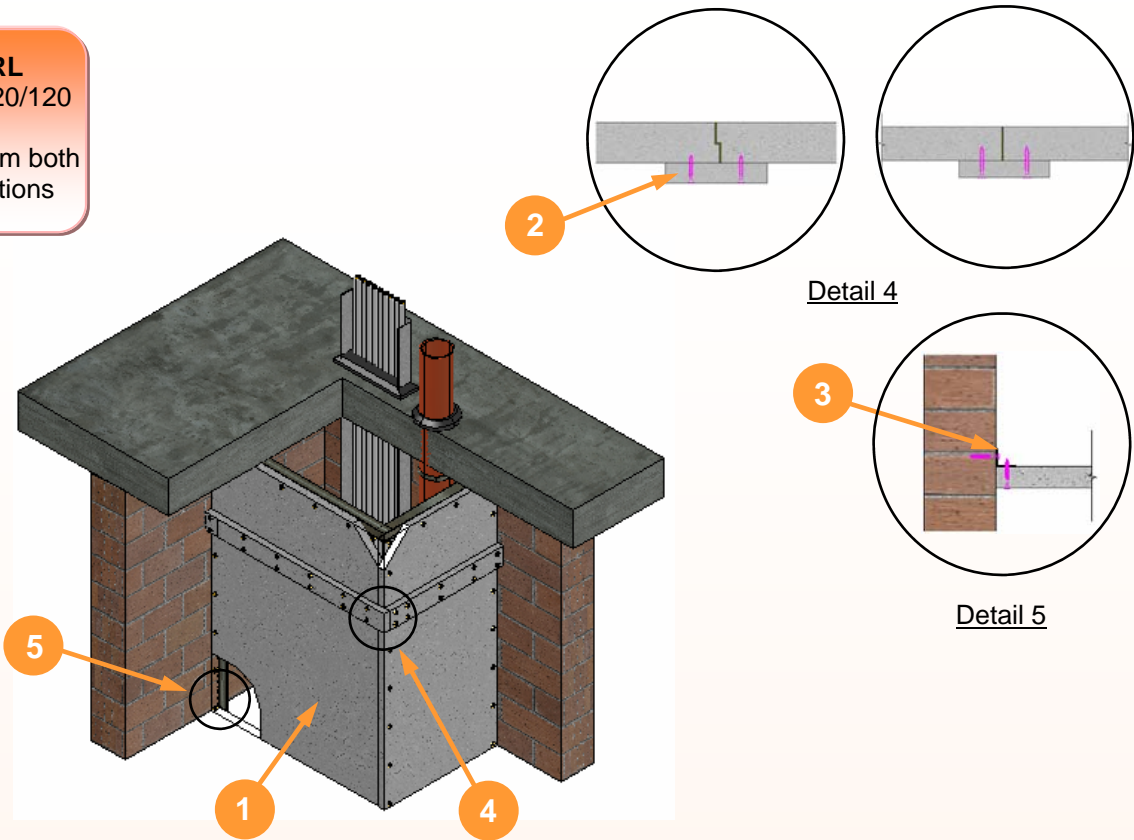

Key:

- 1 Maxilite boards, 60mm thick
- 2 Maxilite cover strips, 30mm thick x 100mm wide
- 3 Steel angles, 50mm x 50mm x 3mm
- 4 Rebate or butt joint detail options
- 5 Angle fixing details

Self-supporting system

Maxilite board	60mm thick board for 2 hour fire rating. Boards are joined together using rebate or butt joints incorporating approved fire mastic in all joints. Boards are screw-fixed to steel angles at max. 200mm centres.
Corners	Corners fixed to steel angles with self tapping screws at 200mm centres.
Joints	Boards are joined by either rebate or butt joints incorporating approved fire mastic. Cover strips are fixed over the joint.
Maxilite cover strips	30mm thick x 100mm wide fixed to outside of joint. Strips are secured to both sides of the joint at max. 200mm centres.
Steel angles	50mm x 50mm x 3mm, fixed to masonry, concrete or plasterboard at max. 600mm centres and screw-fixed to boards.
Fixings	- Board to board / steel angle: M4 - 100mm self tapping screws at 200mm centres. Allow 10 to 15mm from edges of Maxilite board. - Steel angle to masonry or concrete: M6 anchor bolts at 600mm centres. - Steel angle to plasterboard: M4 - 100mm self tapping screws at 600mm centres.

BULKHEAD — VERTICAL

Vertical three-sided bulkhead 60mm thick Maxilite boards, up to 1200mm x 1200mm

FRL
120/120/120
Fire from both directions

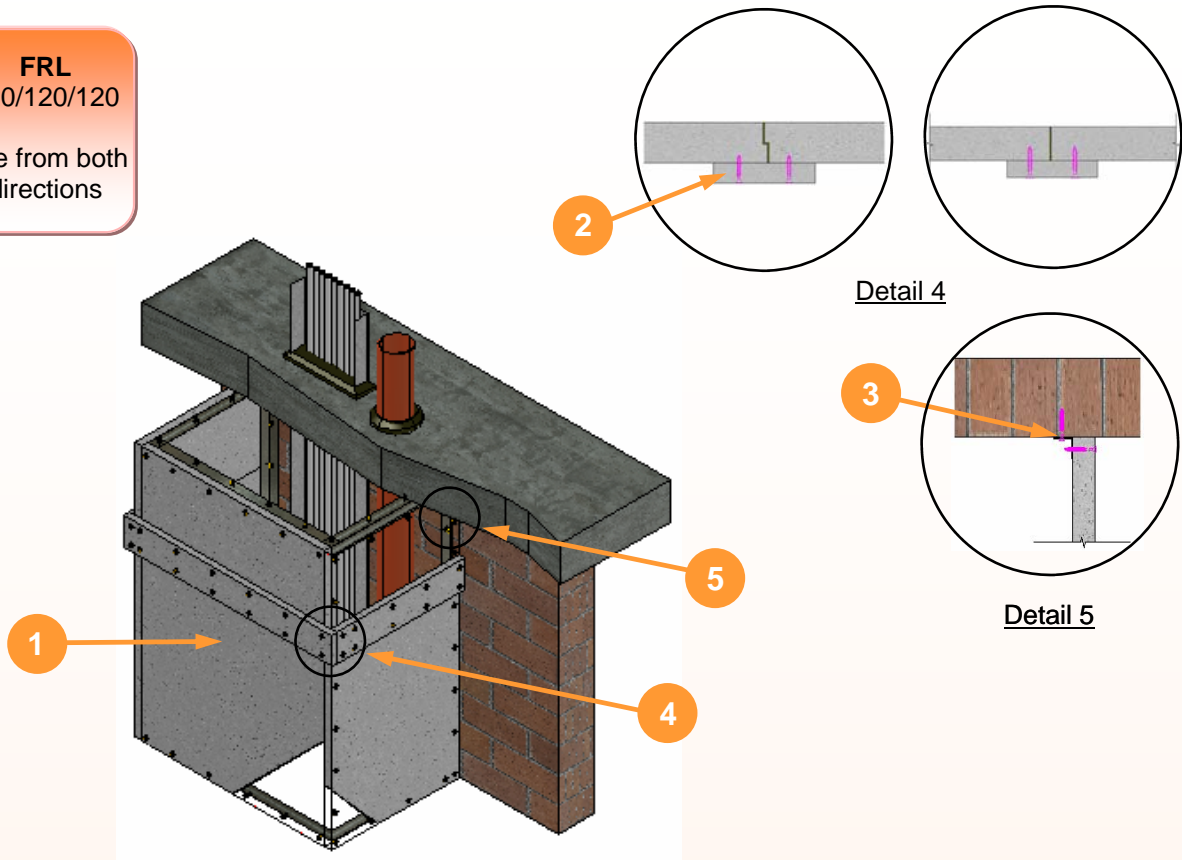

Key:

- 1 Maxilite boards, 60mm thick
- 2 Maxilite cover strips, 30mm thick x 100mm wide
- 3 Steel angles, 50mm x 50mm x 3mm
- 4 Rebate or butt joint detail options
- 5 Angle fixing details

Self-supporting system

Maxilite board	60mm thick board for 2 hour fire rating. Boards are joined together using rebate or butt joints incorporating approved fire mastic in all joints. Boards are screw-fixed to steel angles at max. 200mm centres.
Corners	Corners fixed to steel angles with self tapping screws at 200mm centres.
Joints	Boards are joined by either rebate or butt joints incorporating approved fire mastic. Cover strips are fixed over the joint.
Maxilite cover strips	30mm thick x 100mm wide fixed to outside of joint. Strips are secured to both sides of the joint at max. 200mm centres.
Steel angles	50mm x 50mm x 3mm, fixed to masonry, concrete or plasterboard at max. 600mm centres and screw-fixed to boards.
Fixings	<ul style="list-style-type: none"> - Board to board / steel angle: M4 - 100mm self tapping screws at 200mm centres. Allow 10 to 15mm from edges of Maxilite board. - Steel angle to masonry or concrete: M6 anchor bolts at 600mm centres. - Steel angle to plasterboard: M4 - 100mm self tapping screws at 600mm centres.

BULKHEAD — VERTICAL

Vertical one-sided bulkhead 60mm thick Maxilite boards, up to 1200mm wide

FRL
240/240/240
Fire from both directions

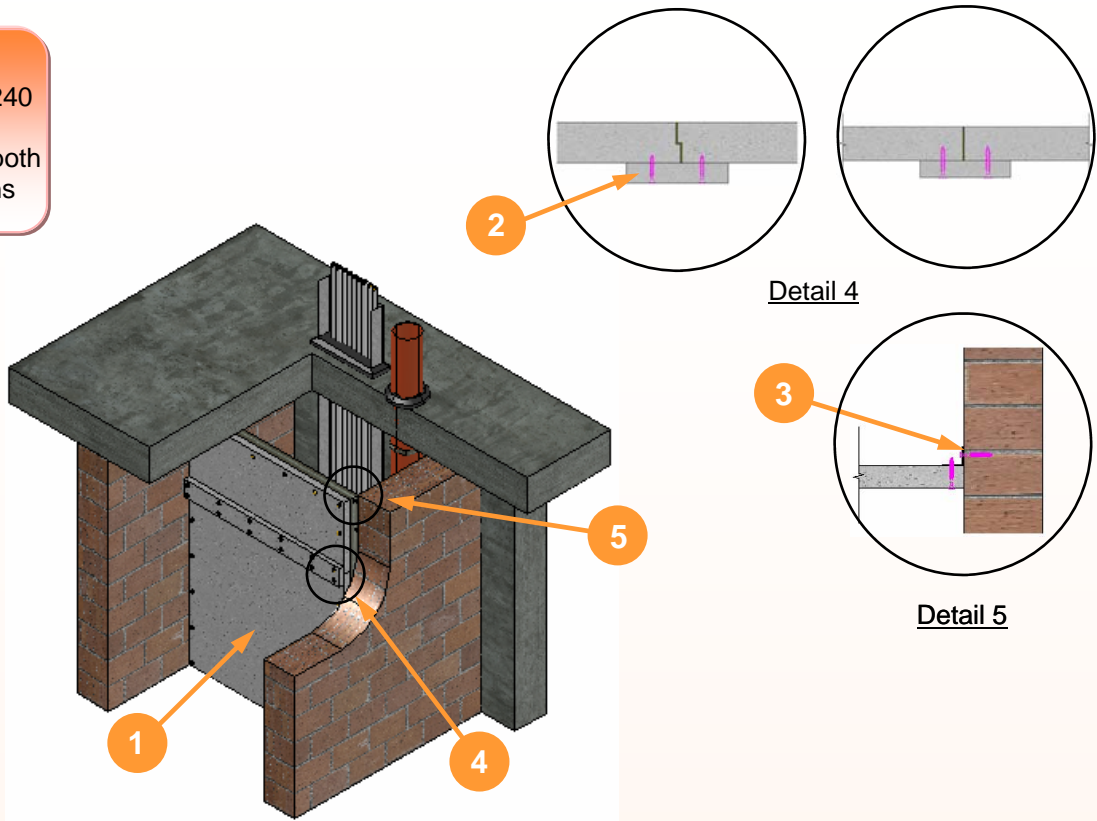

Key:

- 1 Maxilite boards, 60mm thick
- 2 Maxilite cover strips, 30mm thick x 100mm wide
- 3 Steel angles, 50mm x 50mm x 3mm
- 4 Rebate or butt joint detail options
- 5 Angle fixing details

Self-supporting system

Maxilite board	60mm thick board for 4 hour fire rating. Boards are joined together using rebate or butt joints incorporating approved fire mastic in all joints. Boards are screw-fixed to steel angles at max. 200mm centres.
Corners	Corners fixed to steel angles with self tapping screws at 200mm centres.
Joints	Boards are joined by either rebate or butt joints incorporating approved fire mastic. Cover strips are fixed over the joint.
Maxilite cover strips	30mm thick x 100mm wide fixed to outside of joint. Strips are secured to both sides of the joint at max. 200mm centres.
Steel angles	50mm x 50mm x 3mm, fixed to masonry, concrete or plasterboard at max. 600mm centres and screw-fixed to boards.
Fixings	<ul style="list-style-type: none"> - Board to board / steel angle: M4 - 100mm self tapping screws at 200mm centres. Allow 10 to 15mm from edges of Maxilite board. - Steel angle to masonry or concrete: M6 anchor bolts at 600mm centres. - Steel angle to plasterboard: M4 - 100mm self tapping screws at 600mm centres.

BULKHEAD — VERTICAL

Vertical two-sided bulkhead 60mm thick Maxilite boards, up to 1200mm x 1200mm

FRL
240/240/230
Fire from both directions

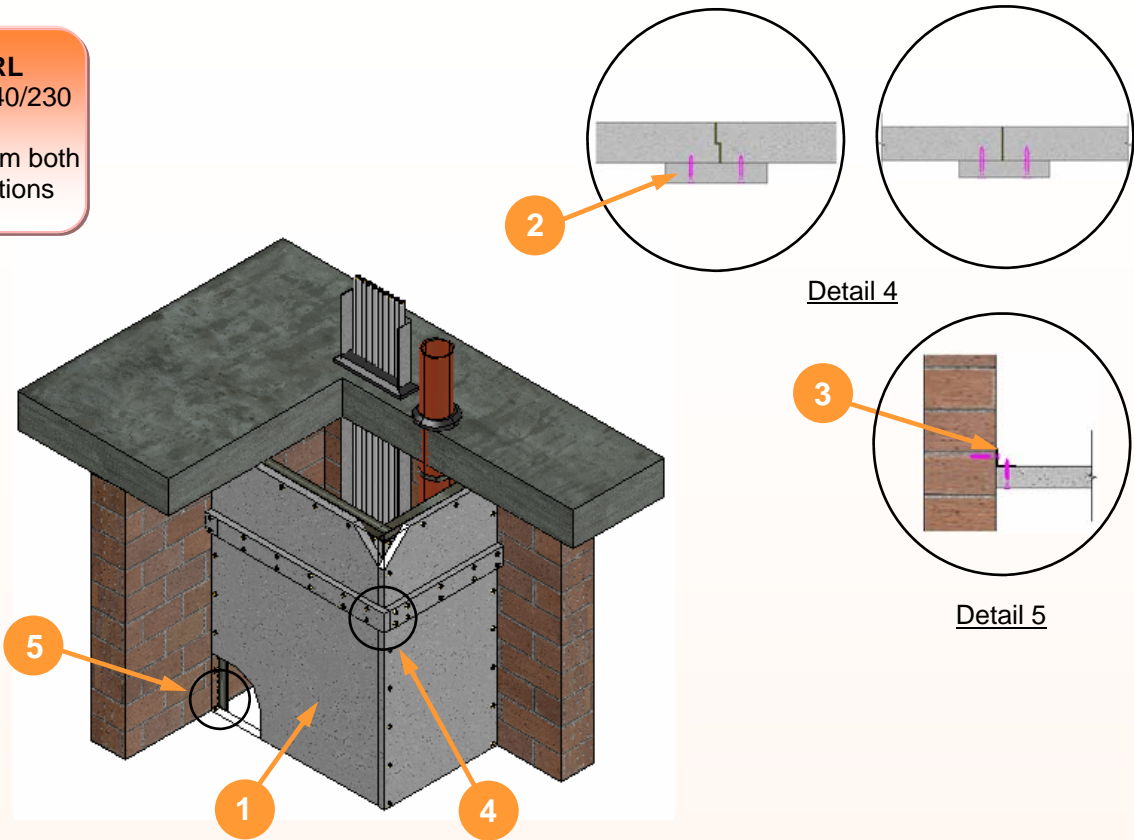

Key:

- 1 Maxilite boards, 60mm thick
- 2 Maxilite cover strips, 30mm thick x 100mm wide
- 3 Steel angles, 50mm x 50mm x 3mm
- 4 Rebate or butt joint detail options
- 5 Angle fixing details

Self-supporting system

Maxilite board	60mm thick board for 4 hour fire rating. Boards are joined together using rebate or butt joints incorporating approved fire mastic in all joints. Boards are screw-fixed to steel angles at max. 200mm centres.
Corners	Corners fixed to steel angles with self tapping screws at 200mm centres.
Joints	Boards are joined by either rebate or butt joints incorporating approved fire mastic. Cover strips are fixed over the joint.
Maxilite cover strips	30mm thick x 100mm wide fixed to outside of joint. Strips are secured to both sides of the joint at max. 200mm centres.
Steel angles	50mm x 50mm x 3mm, fixed to masonry, concrete or plasterboard at max. 600mm centres and screw-fixed to boards.
Fixings	- Board to board / steel angle: M4 - 100mm self tapping screws at 200mm centres. Allow 10 to 15mm from edges of Maxilite board. - Steel angle to masonry or concrete: M6 anchor bolts at 600mm centres. - Steel angle to plasterboard: M4 - 100mm self tapping screws at 600mm centres.

BULKHEAD — VERTICAL

